

INDICATOR, FUSE UNITS 240V~ (1 module)



Functions

- Indicators
 - Serves as indicator for supply or status of load, provide with glass encapsulated neon lamp.
- Fuse Unit
 - Serves as protector against over load.

Bulb / Lamp details

Micro tube lamp size: 6.5 x 28 mm long

Technical Specifications

- Indicator
 - Rated voltage 240VAC.
 - Micro tube lamp size: 6.5 x 28 mm long.
 - Current drawal approximately 0.8mA.
 - Available lens in red colour.
- Fuse Unit
 - Fuse rating: 10/15A.
 - Glass tube size: 6.5 mm dia x 28 mm long.

Nomenclature and Marking

GM modular range is marked with details using laser technology with absolute precision and indelibility.

Different varieties:

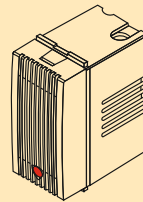

AA 1 026

Indicator with neon tube

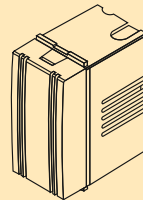

AA 1 027

Fuse 10Amp with glass tube

AA 1 088

Fuse 15Amp with glass tube

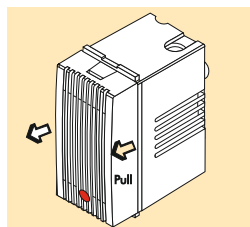

Opening of the assembly

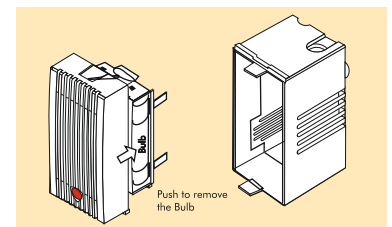

Details showing assembly replacement of Bulb/Glass tube Fuse.

Example of Use

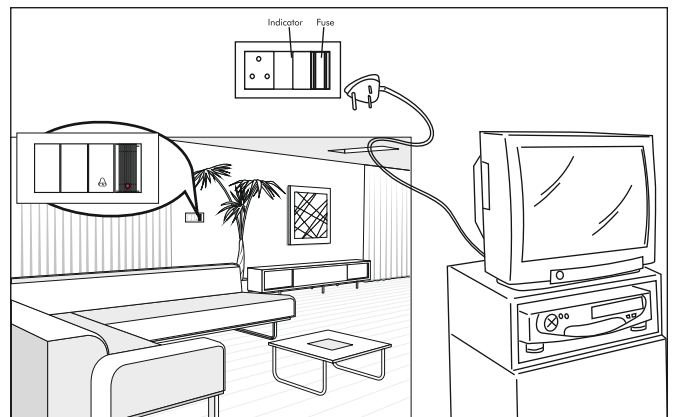

Wiring diagram

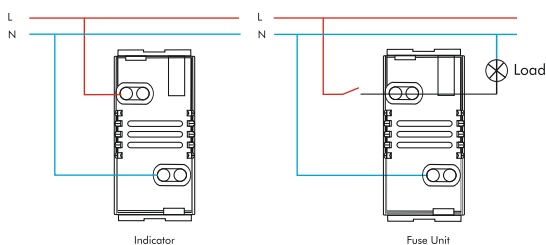

Front and side view showing the over all dimensions in mm

