

6AMP & 10AMP INTERNATIONAL SOCKETS 240V~

(1 module / 2 module)



Functions

- Supply outlet for class I / II electrical appliances, lighting fittings etc.

Technical Specifications

- Rated voltage 240VAC.
- Rated current 6Amp/2.5-10Amp
- IPX4 protection.
- Mould of UV resistant, high impact polycarbonate.
- Unimpaired shutter functions even after 5000 plug pin insertions.
- Insulation resistance tested of 500V dc > 100 M ohms.
- Making & braking capacity 100 plug insertions & withdrawals (100 strokes) with 1.25 times rated current at > 264 volts A.C.
- Resilient contact of high conductivity material.
- Contact block with S.S. pressure plate.
- Specially designed brass component profile to ensure better contact and low temperature rise.
- 'First make' and 'last break' earth connection through earth pin.
- Suitable for 2 pin plugs with 16.4 mm & 19.2 mm pin spacing between L & N.
- Suitable for class I & class II appliance. ⊕ & ⊞
- Provided with child safety shutter.
- Product AA 2 030 suitable for variety of plugs used around the world & also suitable for different types of mobile chargers.

Special Features:

- International socket is compatible with variety of plugs used around the world.
- The International socket is also suitable for different types of mobile chargers.

Nomenclature and Marking

GM modular range is marked with details using laser technology with absolute precision and indelibility.

Different varieties:

1 Module:	AA 1 028	6Amp 2 Pin Euro-American Socket
2 Module:	AA 2 030	10Amp International Socket



International socket compatible with variety of plugs of different countries

Example for Use

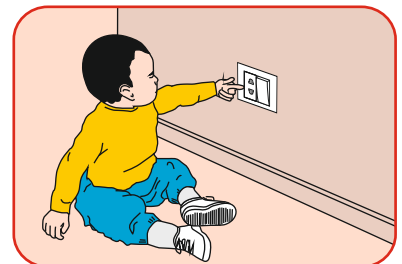
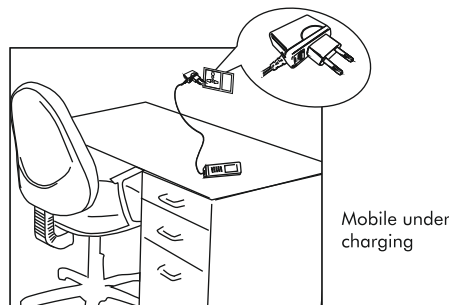
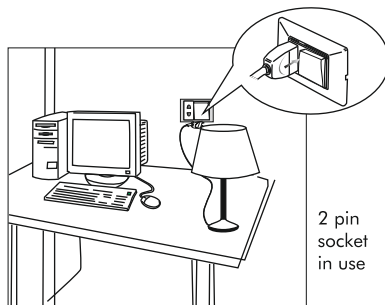

Socket with shutter for child safety

Wiring diagram

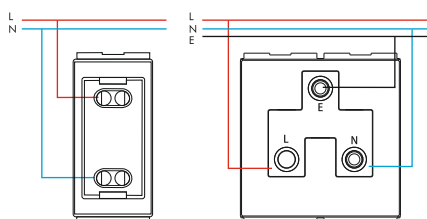

Front and side view showing the over all dimensions in mm

